

- No dimensions are to be scaled from this drawing.
- All dimensions are to be checked on site prior to construction

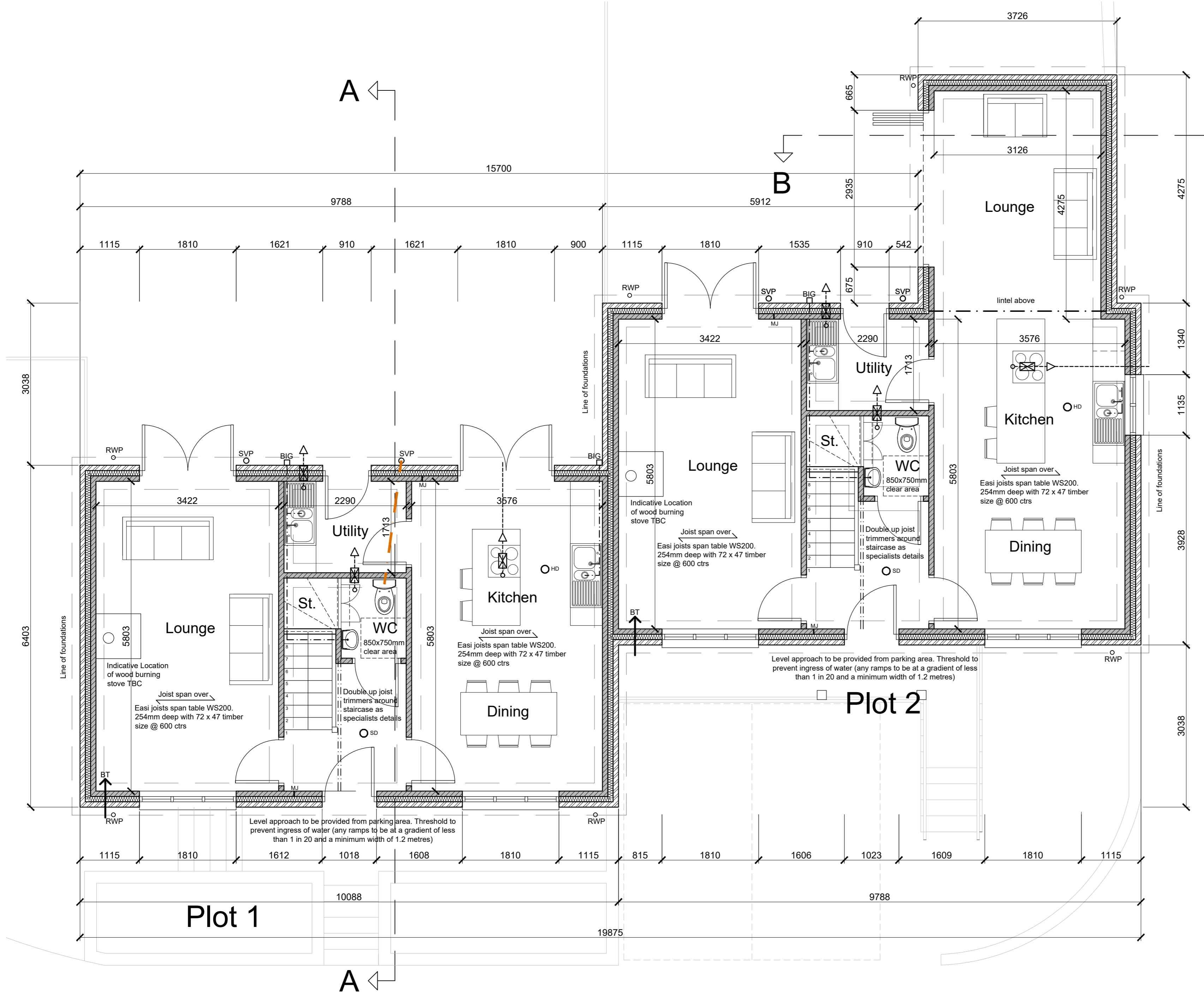

- New timber stud walls with 75 x 50mm sw studs @ 400ctrs with 13mm plasterboard both sides. G/F quilt to WC walls internally  
NOTE: Setting out dims are to finished plasterboard
- Indicates 100mm Blockwork walls
- Indicates Facing brickwork
- IMJ Indicative movement joints to be agreed with engineer & building control on site
- O<sup>SD</sup> Optical Smoke Detector
- O<sup>HD</sup> Heat Detector
- NOTE:  
All steel beams/ lintels up to in loadbearing walls or supporting the intermediate floor are to be min. one hour fire protected
- SVP Soil Vent Pipe
- BIG Back Inlet Gulley
- Mechanical Extract

Plot 1 & 2 - Proposed Ground Floor Plan - 1:50

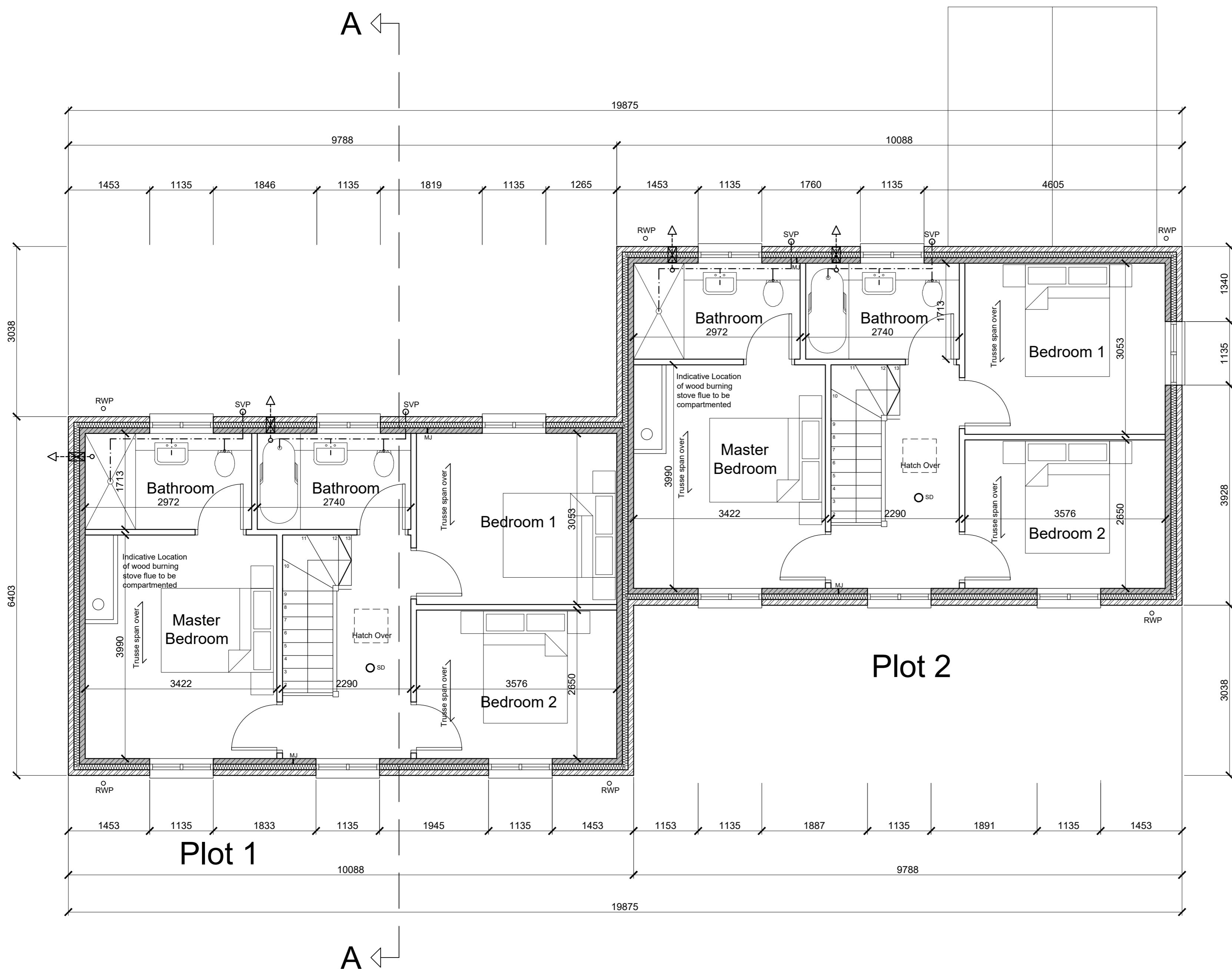

SCALE 1 : 50

Revision	Date Issued	Details
A02	31.08.22	Plot 2 porch edit
A01	30.03.22	Indicative MJs added

**BUILDING REGS**

Studio 2, Deepdale Enterprise Park,  
Deepdale Lane,  
Nettleham, Lincoln  
LN2 2LL

**LK2**

T 01522 750777  
E info@lk2.co.uk  
W www.lk2.co.uk

Registered in England 0205944 - Reg. Office: Studio 2, Deepdale Enterprise Park, Deepdale Lane, Nettleham Lincoln, LN2 2LL

Client Logo

CHERRY TREE HOMES

Client  
Cherry Tree Homes

Project  
6No. Dwellings  
Cow Lane  
Tealby

Drawing Title  
Plot 1 & 2  
Proposed Floor Plans

Scale	Date	Drawn by	Checked by
1:50 at A1	Feb 2022	AJS	AN
Project No.	Drawing No.	Revision	
1311	(20) 001	A02	

Plot 1 & 2 - Proposed First Floor Plan - 1:50